

ALL ST/ST PRESSURE GAUGE TETROPRESS 300



The pressure gauge series TP300 can be installed on chemical, petrochemical plants, onshore and offshore applications, machinery, food processing and in the pharmaceutical industry.



PED 97/23/CE
ATEX 94/9/CE



GOST R PATTERN
APPROVAL

ATEX and GOST R PATTERN approvals available under our **PCI TEMA** brand.

TECHNICAL CHARACTERISTICS

Diameters: 40-50-63-80-100-125-150-200 mm

Case and ring: st. st. 304, bayonet type ring

Protection degree : IP55/IP65 (EN60529/IEC529)

Window: plexiglass

Movement: st. st., reinforced

Dial: aluminium with black numerals on white background

Pointer: Aluminium, black painted, micrometric adjustable

Blow out: neoprene, upper

Sensing element: Bourdon tube type, with "C" form for pressure ≤ 60 bar, helical wound for pressure ≥ 60 bar

Element material : AISI 316L , MONEL 400

Socket material: AISI 316L , MONEL 400

Welding: T.I.G.

Connection dimension: ½"NPTM or BSP/M (1/4" for DN63)

Mounting:

type A bottom connection, direct mounting

type B panel mounting, clamp fixing, back connection

type C surface mounting, bottom connection

type D back connection, direct mounting

type DC center back connection, direct mounting

type E panel mounting, back connection

type EC panel mounting, center back connection

Ranges: see table at page 2

Overpressure: +30% F.S. for range up to 60bar

+15% F.S. for ranges from 100 to 600bar

+10% F.S. for ranges from 1000 bar

Accuracy: class 1, acc. to EN837 (class 1,6 for DN63) at 20°C

Ambient temperature limit: -40/+60°C

Fluid temperature limit:

-30/+200°C element in AISI316L

-30/+230°C element in MONEL

Temperature error: 0,035%/°C in range 0/60°C

Construction acc. to ATEX directive 94/9/EC, gr.II cat. 2GDc (on request)

Construction according to PED directive 97/23/EC (on request)

OPTIONS AND ACCESSORIES

- Overpressure 100% A.C.
- Accuracy 0,5%
- Case st. st. 316
- Acrylic window with max value pointer settable from front
- Safety glass window
- Glycerine filling for T.amb. -25/+60°C
- Silicon oil filling for T.amb.-40/+60°C
- Filling with fluorinated oil suitable for use on Oxygen and for ambient temperature -60/60°C
- Internal dampener
- Mounting with diaphragm seal
- Electrical contacts
- Pulsation dampener, overpressure protector, syphon, needle valve

HOW TO ORDER

Please specify: model, mounting, case diameter, range, connection, options if any

Example : TP300, A, 100mm, 0/10bar, ½"BSPM

RANGES

Pressure																	
Bar	0/0,6	0/1	0/1,6	0/2,5	0/4	0/6	0/10	0/16	0/25	0/40	0/60	0/100	0/160	0/250	0/315	0/400	0/600
psi		0/15	0/30	0/60	0/100	1/160	0/200	0/300	0/400	0/600	0/800	0/1000	0/1500	0/2000	0/5000	0/6000	0/10000
	0/1000	0/1600															
	0/15000	0/20000															

Available on request double scale : bar/psi –bar/kPa – psi/kg/cm² – kPa/psi

Receiver					
psi	0/20	0/30	0/40	0/60	3/15

Available on request double scale : 3/15 , 0/10 linear – 3/15 , 0/10 √

Vacuum and compound								
Bar	-1/0	-1/+0,6	-1/+1,5	-1/3	-1/5	-1/9	-1/15	-1/+24
kPa	-100/0		-100/+150	-100/+300	-100/+500	-100/+900	-100/+1500	-100/+2400

Available on request double scale : bar/Hg-psi –bar/kPa – Hg-psi/kg/cm² – kPa/Hg-psi

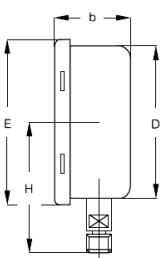

Type A: Direct mounting, radial connection

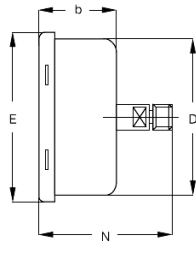

Type DC: Direct mounting, rear central connection

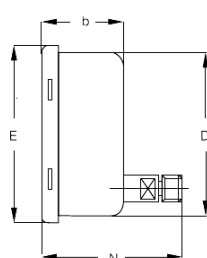

Type D: Direct mounting, rear eccentric connection

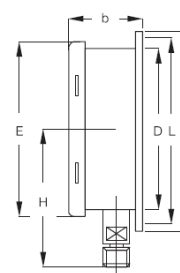

Type C: Wall mounting with rear flange, radial connection

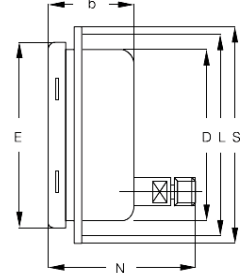

Type E: Panel mounting, 3 hole front flange, rear eccentric connection

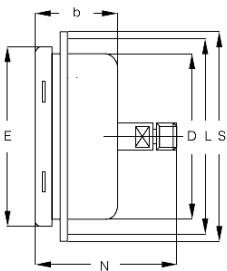

Type EC: Panel mounting, 3 hole front flange, rear central connection

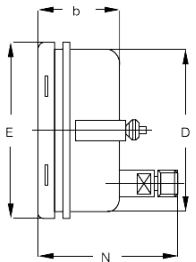

Type B: Panel mounting, "U" type rear bracket, rear eccentric connection

DS	b	D	E	H	L	N	S	f	WEIGHT IN kg DRY	WEIGHT IN Kg GLYCERINE FILLED
63	30	63	68	52	75	50	85	¼"BSP/NPT	0,200	0,300
80	47	80	88	63	97	82	102	½"BSP/NPT	0,400	0,600
100	51	101	115	87	116	87	130	½"BSP/NPT	0,700	1,050
125	51	127	121	106	150	87	170	½"BSP/NPT	1,200	1,500
150	57	150	166	125	175	89	190	½"BSP/NPT	1,400	1,900
200	57	200	218	170	205	100	245	½"BSP/NPT	2,100	3,000