

BOLTED CHEMICAL SEAL BCS Series



Compact bolted chemical seal with an internal welded diaphragm suitable for dismantling and internal washing. Also available with male process connections.

BCS150 Model Range -1/150 bar
BCS250 Model Range 0/250 bar



SPECIFICATIONS

Seal: st. st. AISI316

Diaphragm: st. st. AISI316L

Ranges: BSC150 model -1/150 bar, BCS250 model 0/250 bar

Accuracy: at 20°C or at temperature stated when ordering: $\pm 0,5\%$ for direct line, $\pm 1\%$ for flexible line

Process connection: $\frac{1}{2}$ " threaded BSP / NPT Male or female

Flushing connection: $\frac{1}{8}$ " NPT upon request

TYPES AND DIMENSION

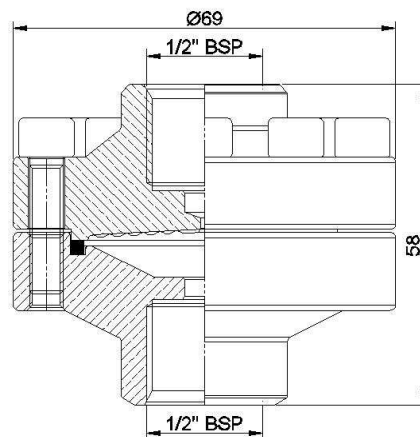

Available with male or female process connection

OPTIONS

- **Diaphragm material:** st. st. AISI 316, Monel, Hastelloy, Tantalum,
- **Bottom housing:** Monel, Hastelloy.

HOW TO ORDER

Please specify : model, process connection, options if any

Example : BCS150, $\frac{1}{2}$ "BSPM